

Technical data sheet

Product features



Pot and pan washer double skin 70x70 - 400 V

Model	SAP Code	00011972
--------------	-----------------	----------



- Display type: LCD multifunction display
- Number of programs: 8
- Number of skin: 2
- Door clear height [mm]: 850
- Rack size [mm]: 700 x 700
- Water consumption of the washing cycle [l/basket]: 4
- Washing cycle time [s/basket]: 120-240-360-720 sec.
- Detergent and rinse pump system: ProDose - accurate dosing with a peristaltic pump
- Wash pump type: two-way - DuoFlow
- Self-cleaning cycle: Yes
- Drain filter: ArchiMedes - double filtration with overflow discharge ensures only 18% loss of clean water to waste

SAP Code	00011972	Boiler power [kW]	8.000
Net Width [mm]	857	Basin volume [l]	68
Net Depth [mm]	853	Tank power [kW]	8.000
Net Height [mm]	1959	Water consumption of the washing cycle [l/basket]	4
Net Weight [kg]	181.00	Washing cycle time [s/basket]	120-240-360-720 sec.
Power electric [kW]	18.700	Door clear height [mm]	850
Loading	400 V / 3N - 50 Hz	Rack size [mm]	700 x 700
Boiler capacity [l]	12.00		

Technical data sheet

Technical drawing



Pot and pan washer double skin 70x70 - 400 V

Model

SAP Code

00011972

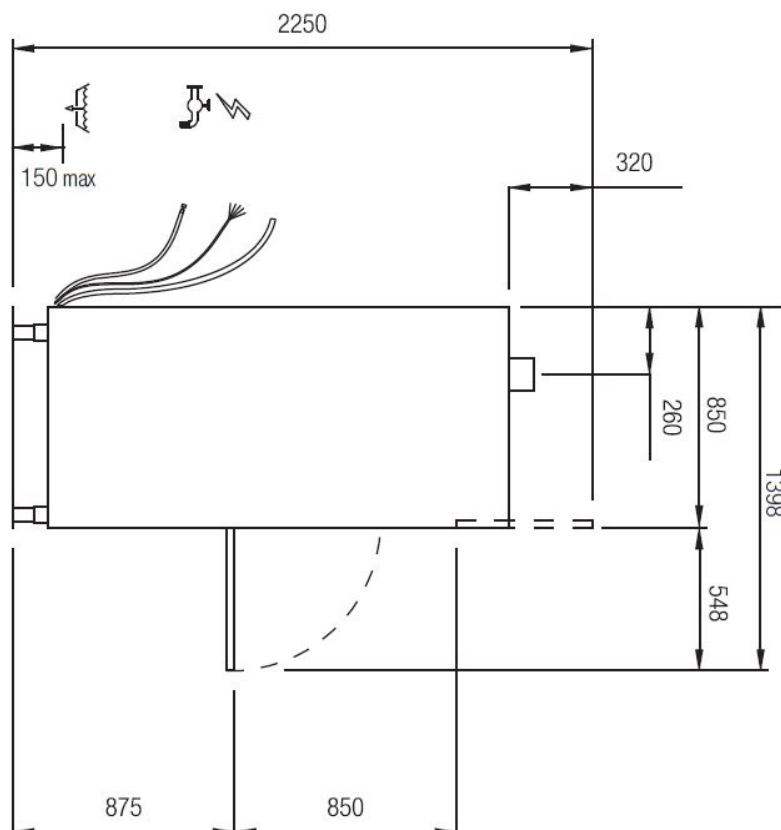
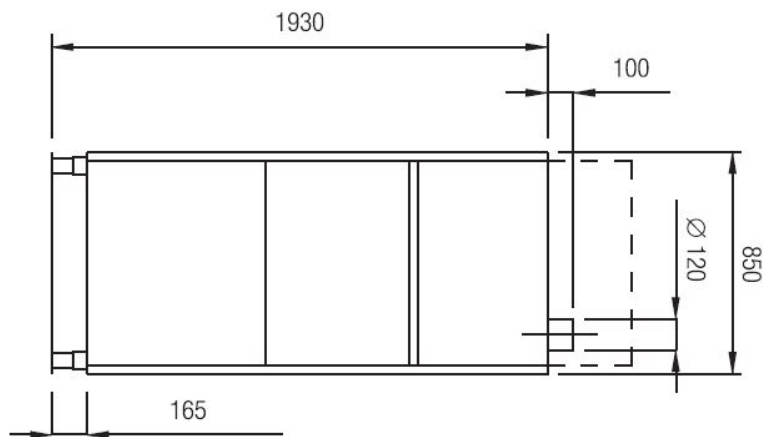

Technical data sheet

Product benefits



Pot and pan washer double skin 70x70 - 400 V

Model

SAP Code

00011972

1

Stainless steel outer shell construction

round construction with stainless steel, rounded edges, Deep-drawn bathtub

- easy cleaning, high hygiene standard, long service life

2

Stainless steel washing arms

upper and lower arms with stainless steel, separated for washing and rinsing, triple upper arm

- easy and safe handling during cleaning; higher user comfort

3

LED Display

smartScreen, a large color graphic display showing the washing progress

- easy control of the dishwasher operation
- continuous information on the status of the wash cycle
- diagnostics in the event of a fault

4

Double pump

unique two-way DuoFlow pump

- distributes the water pressure evenly between the upper and lower arms; no noise; allows the use of a weaker pump

5

Detergent dispensers

two detergent and rinse aid dispensers

- precise chemical dosing by ProDose - precise dosing system for detergent and rinse aid by peristaltic pump setting of values via control panel

6

Double filter system

the chamber filter and the waste filter together with the ArchiMedes system provide a discharge system with increased water purification efficiency

- higher washing efficiency; longer life of the washing bath

7

Energy saving

energy saving energy saving system due to lowering the temperature of the boiler

- cost saving

8

Protection of fragile dishes

softstart system for gradual start of washing programs to protect fragile dishes

- protects stemmed glasses and other fragile utensils

9

Double shell construction

stainless steel construction with insulated double jacket

- quiet operation
- energy saving

10

Fast heating

performance management allows the current running of the boiler and basins body

- quick first warm-up of the dishwasher
- smooth operation

11

Air break tank

the open system of the boiler rinse, in cooperation with the rinse pump, ensures a constant pressure and temperature of the rinse

- possibility to use in HACCP systems water temperature suitable for sterilization

Technical data sheet

Technical parameters



Pot and pan washer double skin 70x70 - 400 V

Model	SAP Code
	00011972

1. SAP Code:

00011972

2. Net Width [mm]:

857

3. Net Depth [mm]:

853

4. Net Height [mm]:

1959

5. Net Weight [kg]:

181.00

6. Gross Width [mm]:

100

7. Gross depth [mm]:

950

8. Gross Height [mm]:

2200

9. Gross Weight [kg]:

191.00

10. Device type:

Electric unit

11. Control type:

Digital

12. Material:

AISI 304

13. Power electric [kW]:

18.700

14. Loading:

400 V / 3N - 50 Hz

15. Number of programs:

8

16. Opening of device:

Tilting down

17. Door clear height [mm]:

850

18. Inlet pressure [bar]:

1-6

19. Adjustable feet:

Yes

20. Number of skin:

2

21. Self-cleaning cycle:

Yes

22. Boiler capacity [l]:

12.00

23. Boiler power [kW]:

8.000

24. Basin volume [l]:

68

25. Tank power [kW]:

8.000

26. Number of arms for both rinsing and washing:

2

27. Arm connection:

Hand loosen/tighten screw

28. Washing arm type:

Rotating trident

Technical data sheet

Technical parameters



Pot and pan washer double skin 70x70 - 400 V

Model

SAP Code

00011972

29. Washing arm material:

Stainless steel

30. Atmospheric boiler with rinse pump:

Yes

31. Rinsing arm type:

Rotating trident

32. Rinsing arm material:

Stainless steel

33. Deep drawn tank:

Yes

34. Rack support:

Pressed

35. Tank surface strainers:

stainless steel

36. Drain filter:

ArchiMedes - double filtration with overflow discharge ensures only 18% loss of clean water to waste

37. Thermostop:

Yes

38. Boiler thermostat adjust:

Yes

39. Detergent and rinse pump system:

ProDose - accurate dosing with a peristaltic pump

40. Energy Saving system:

EnergySaving - Energy saving system due to lowering the boiler temperature

41. Rinse system:

UltraRinse2 - stainless steel rinsing arms including stainless steel nozzles with a geometry for spraying water in thin jets directly against the dishes, the rinsing pump ensures constant pressure

42. Heating system:

HotWash - System of simultaneous operation of the heating element of the bath and the boiler, reducing the time for starting the next cycle

43. Quick heating system:

QuickReady - System for rapid heating of water in the tank

44. Hot water electric valve:

Yes

45. Closing door system:

ProSoft - Reduces noise, dampens the door stop, which could cause damage to dishes

46. Rack size [mm]:

700 x 700

47. Display type:

LCD multifunction display

48. USB port:

Yes, for Firmware actualisation

49. Self-diagnostics:

Yes

50. Wash pump type:

two-way - DuoFlow

Technical data sheet

Technical parameters



Pot and pan washer double skin 70x70 - 400 V

Model

SAP Code

00011972

51. Detergent dispenser:

Yes

52. Rinse aid dispenser:

Yes

53. Water consumption of the washing cycle [l/basket]:

4

54. Washing cycle time [s/basket]:

120-240-360-720 sec.

55. Rinse water temperature [°C]:

80-85

56. Additional information:

The product comes with 1x RM Clean+ 12 kg (00012271) and 1x RM Rinse+ 10 kg (00012273) for free

57. Program ProFessional 2:

Yes

58. Program ProFessional 4:

Yes

59. Program ProFessional 6:

Yes

60. Program ProFessional 8:

Yes

61. Program ProFessional 10:

Yes

62. Program ProSelf:

Yes

63. Program ProEco:

Yes

64. Program ProLong:

Yes